

IK-201

2-Element Multi-Band 5G/ LTE Antenna



The CCX Technologies IK-201 is a two-element multi-band 5G/LTE antenna intended for installation within the cabin of an aircraft. At just 0.6 inches tall the antenna can be conveniently installed under a headliner, or behind almost any panel with no additional adapter brackets.

The IK-200 uses D-Sub Coax Connectors, which – unlike SMA connectors – will stay securely fastened in high-vibration environments. The pins in the D-Sub Coaxial Connectors can also be crimped to larger diameter coaxial cables providing additional installation options with longer length, very low-loss cables.

This directional antenna connects directly to the router/server and utilizes the IEEE 802.11ac WiFi standard to deliver enhanced signal strength to passengers and equipment onboard an aircraft.

Features

- Covers all 4G, LTE, and 5G frequencies
- Size, Weight, and Power (SWaP) optimized
- Easy to install with D-Sub coax connectors
- Radiating pattern designed for use in aircraft cabin
- Can be used with SystemX or 3rd party router or wireless access point

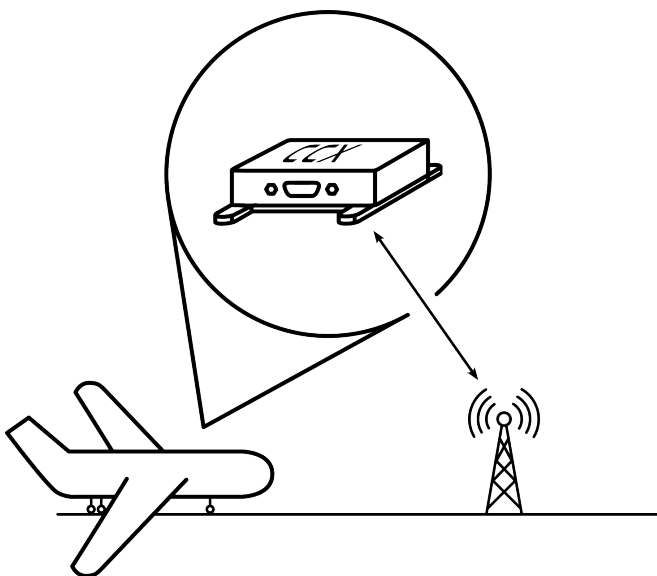

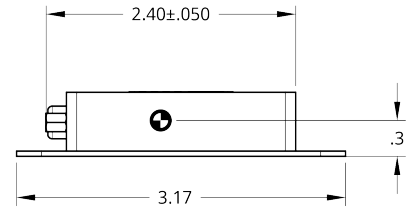
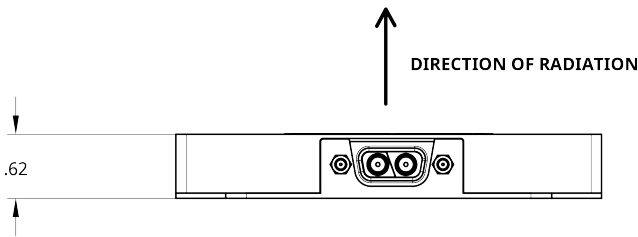
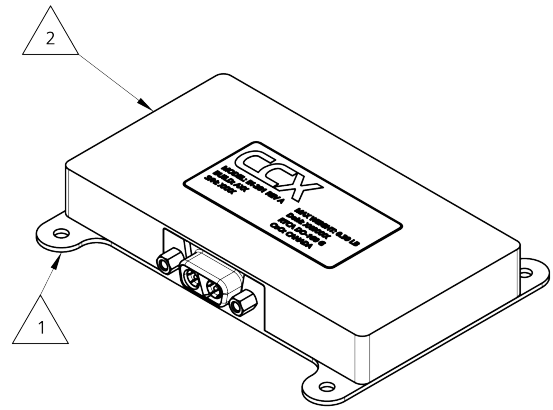
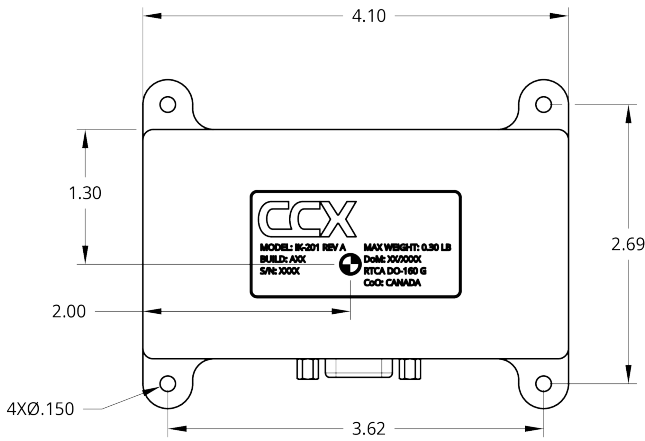

Technical Information

Dimensions	2.25"L x 4.25"W x 0.60"H
Weight	0.3lb
Mounting Provisions	4 mounting holes for #6 bolts or screws; flange mount.
Connectors	MIL-DTL-24308G 2W2 Female D-sub
Bandwidth	600MHz-6GHz
Input Impedance	50 ohms
Average Gain	617MHz-698MHz: -3.9dBi 698MHz-806MHz: -3.1dBi 824MHz-960MHz: -2.7dBi 1427MHz-1518MHz: -5.4dBi 1710MHz-2200MHz: -1.7dBi 2490MHz-2690MHz: -2.7dBi 3300MHz-5000MHz: -3.7dBi 5150MHz-5925MHz: -2.9dBi
Peak Gain	617MHz-698MHz: -0.7dBi 698MHz-806MHz: 0.5dBi 824MHz-960MHz: 1dBi 1427MHz-1518MHz: -0.5dBi 1710MHz-2200MHz: 3.4dBi 2490MHz-2690MHz: 2.9dBi 3300MHz-5000MHz: 4.3dBi 5150MHz-5925MHz: 3dBi
Environmental Qualifications	RTCA DO-160G

Interfaces

QTY	Interfaces	Standards
2	RF Interface	5G/LTE/3G 600MHz-6GHz

Contact us:

 ccxtechnologies.com

 info@ccxtechnologies.com

 +1 (613) 695-9434

Powered
by

